

Township No 54 N. Range No 16 W. 4<sup>th</sup> Mer. Minnesota.

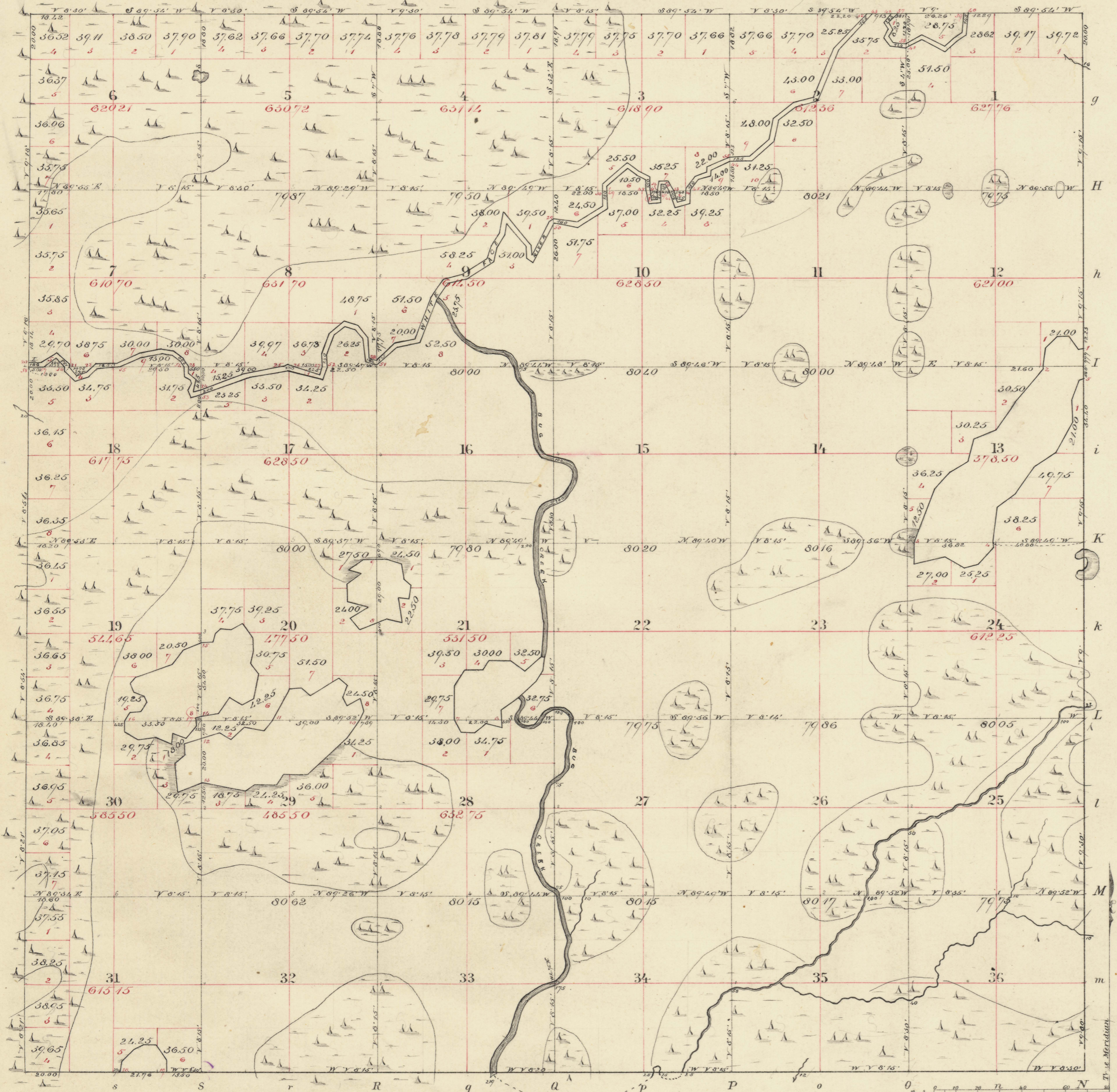

| Meanders.                           |         |                 |                      |       |         |                 |                      |       |         |                 |     |
|-------------------------------------|---------|-----------------|----------------------|-------|---------|-----------------|----------------------|-------|---------|-----------------|-----|
| Posts                               | Courses | Ch <sup>s</sup> | Lks                  | Posts | Courses | Ch <sup>s</sup> | Lks                  | Posts | Courses | Ch <sup>s</sup> | Lks |
| LAKE in Sec <sup>o</sup> 12, 13, 21 |         |                 | T 11 <sup>th</sup> N |       |         | 6.75            | Sec <sup>o</sup> 19  |       |         |                 |     |
| Sec <sup>o</sup> 12                 |         |                 | T 11 <sup>th</sup> N |       |         | 7.00            | S 65 <sup>th</sup> W |       |         | 9.00            |     |
| 1                                   | West    | 2.25            | 9 West               |       |         | 4.50            | S 10 <sup>th</sup> W |       |         | 8.00            |     |
| West                                |         |                 | S 38 <sup>th</sup> W |       |         | 7.00            | S 71 <sup>th</sup> W |       |         | 18.00           |     |
| West                                |         |                 | S 47 <sup>th</sup> W |       |         | 6.50            | 9 West               |       |         | 5.50            |     |
| S 26 <sup>th</sup> W                |         |                 | S 52 <sup>th</sup> W |       |         | 7.00            | S 34 <sup>th</sup> E |       |         | 4.00            |     |
| S 7 <sup>th</sup> W                 |         |                 | S 70 <sup>th</sup> E |       |         | 5.00            | S 61 <sup>th</sup> E |       |         | 4.25            |     |
| S 55 <sup>th</sup> W                |         |                 | S 75 <sup>th</sup> E |       |         | 7.50            | S 39 <sup>th</sup> W |       |         | 3.75            |     |
| S 26 <sup>th</sup> W                |         |                 | S 26 <sup>th</sup> E |       |         | 3.00            | S 62 <sup>th</sup> W |       |         | 6.00            |     |
| S 42 <sup>th</sup> W                |         |                 | S 75 <sup>th</sup> E |       |         | 10.00           | S 35 <sup>th</sup> W |       |         | 4.00            |     |
| S 35 <sup>th</sup> W                |         |                 | S 25 <sup>th</sup> E |       |         | 7.00            | Sec <sup>o</sup> 30  |       |         |                 |     |
| S 67 <sup>th</sup> W                |         |                 | S 29 <sup>th</sup> E |       |         | 3.00            | S 61 <sup>th</sup> E |       |         | 4.10            |     |
| S 16 <sup>th</sup> W                |         |                 | S 20 <sup>th</sup> E |       |         | 10.00           | S 61 <sup>th</sup> E |       |         | 7.00            |     |
| S 36 <sup>th</sup> W                |         |                 | S 20 <sup>th</sup> E |       |         | 10.00           | S 66 <sup>th</sup> E |       |         | 3.50            |     |
| S 44 <sup>th</sup> W                |         |                 | S 26 <sup>th</sup> E |       |         | 5.00            | S 69 <sup>th</sup> E |       |         | 7.70            |     |
| S 22 <sup>th</sup> W                |         |                 | S 15 <sup>th</sup> E |       |         | 6.00            | S 62 <sup>th</sup> E |       |         | 7.75            |     |
| S 24 <sup>th</sup> W                |         |                 | S 30 <sup>th</sup> E |       |         | 4.00            | S 6 <sup>th</sup> W  |       |         | 2.50            |     |
| S 27 <sup>th</sup> W                |         |                 | S 70 <sup>th</sup> E |       |         | 14.50           | S 70 <sup>th</sup> E |       |         | 1.50            |     |
| S 64 <sup>th</sup> E                |         |                 | S 50 <sup>th</sup> W |       |         | 5.00            | S 79 <sup>th</sup> E |       |         | 2.10            |     |
| S 33 <sup>th</sup> E                |         |                 | S 60 <sup>th</sup> W |       |         | 15.00           | S 70 <sup>th</sup> E |       |         | 5.00            |     |
| S 44 <sup>th</sup> E                |         |                 | S 50 <sup>th</sup> W |       |         | 10.00           | S 37 <sup>th</sup> E |       |         | 7.50            |     |
| S 20 <sup>th</sup> E                |         |                 | S 75 <sup>th</sup> W |       |         | 9.00            | S 2 <sup>th</sup> E  |       |         | 5.00            |     |
| S 19 <sup>th</sup> E                |         |                 | S 70 <sup>th</sup> E |       |         | 17.5            | LAKE                 |       |         |                 |     |
| S 70 <sup>th</sup> E                |         |                 | S 70 <sup>th</sup> W |       |         | 8.00            | S 29 <sup>th</sup> E |       |         | 4.00            |     |
| S 70 <sup>th</sup> W                |         |                 | S 40 <sup>th</sup> W |       |         | 6.00            | S 27 <sup>th</sup> E |       |         | 9.00            |     |
| S 37 <sup>th</sup> E                |         |                 | S 30 <sup>th</sup> W |       |         | 9.00            | S 79 <sup>th</sup> E |       |         | 4.00            |     |
| S 55 <sup>th</sup> E                |         |                 | S 50 <sup>th</sup> W |       |         | 7.80            | S 37 <sup>th</sup> E |       |         | 6.00            |     |
| S 30 <sup>th</sup> E                |         |                 | S 60 <sup>th</sup> W |       |         | 6.00            | S 37 <sup>th</sup> E |       |         | 7.50            |     |
| S 19 <sup>th</sup> E                |         |                 | S 75 <sup>th</sup> W |       |         | 9.00            | S 2 <sup>th</sup> E  |       |         | 5.00            |     |
| S 70 <sup>th</sup> E                |         |                 | S 70 <sup>th</sup> W |       |         | 8.00            | White Face River     |       |         |                 |     |
| S 70 <sup>th</sup> W                |         |                 | S 70 <sup>th</sup> W |       |         | 5.00            | Right bank           |       |         |                 |     |
| S 30 <sup>th</sup> E                |         |                 | S 50 <sup>th</sup> W |       |         | 5.00            | S 20 <sup>th</sup> E |       |         | 1.00            |     |
| S 4 <sup>th</sup> E                 |         |                 | S 4 <sup>th</sup> W  |       |         | 12.50           | S 60 <sup>th</sup> E |       |         | 9.25            |     |
| S 79 <sup>th</sup> W                |         |                 | S 54 <sup>th</sup> W |       |         | 6.00            | S 47 <sup>th</sup> E |       |         | 8.00            |     |
| S 29 <sup>th</sup> W                |         |                 | S 29 <sup>th</sup> W |       |         | 5.50            | S 21 <sup>th</sup> E |       |         | 1.00            |     |
| S 29 <sup>th</sup> W                |         |                 | S 30 <sup>th</sup> E |       |         | 2.00            | S 40 <sup>th</sup> E |       |         | 5.75            |     |
| S 60 <sup>th</sup> E                |         |                 | S 60 <sup>th</sup> E |       |         | 5.00            | S 69 <sup>th</sup> E |       |         | 4.00            |     |
| S 31 <sup>th</sup> E                |         |                 | S 40 <sup>th</sup> E |       |         | 6.00            | S 50 <sup>th</sup> E |       |         | 4.10            |     |
| S 38 <sup>th</sup> E                |         |                 | S 49 <sup>th</sup> E |       |         | 22.75           | S 30 <sup>th</sup> E |       |         | 2.00            |     |
| S 38 <sup>th</sup> E                |         |                 | S 36 <sup>th</sup> E |       |         | 11.00           | S 48 <sup>th</sup> E |       |         | 10.50           |     |
| S 53 <sup>th</sup> E                |         |                 | S 50 <sup>th</sup> E |       |         | 10.00           | S 64 <sup>th</sup> E |       |         | 10.25           |     |
| S 30 <sup>th</sup> E                |         |                 | S 30 <sup>th</sup> E |       |         | 7.75            | S 79 <sup>th</sup> E |       |         | 10.00           |     |
| S 10 <sup>th</sup> W                |         |                 | S 35 <sup>th</sup> E |       |         | 9.00            | S 33 <sup>th</sup> E |       |         | 5.50            |     |
| S 31 <sup>th</sup> W                |         |                 | S 63 <sup>th</sup> E |       |         | 6.75            | S 51 <sup>th</sup> E |       |         | 5.50            |     |
| S 47 <sup>th</sup> W                |         |                 | S 62 <sup>th</sup> E |       |         | 6.00            | S 27 <sup>th</sup> E |       |         | 5.00            |     |
| S 51 <sup>th</sup> W                |         |                 | S 44 <sup>th</sup> E |       |         | 11.00           | S 18 <sup>th</sup> E |       |         | 3.25            |     |
| S 26 <sup>th</sup> W                |         |                 | S 35 <sup>th</sup> W |       |         | 6.00            | S 52 <sup>th</sup> E |       |         | 4.50            |     |
| S 10 <sup>th</sup> E                |         |                 | S 10 <sup>th</sup> E |       |         | 6.00            | S 14 <sup>th</sup> W |       |         | 5.50            |     |
| S 36 <sup>th</sup> W                |         |                 | S 36 <sup>th</sup> W |       |         | 8.00            | S 71 <sup>th</sup> E |       |         | 4.00            |     |
| S 29 <sup>th</sup> E                |         |                 | S 65 <sup>th</sup> W |       |         | 9.75            | S 17 <sup>th</sup> E |       |         | 1.00            |     |
| S 71 <sup>th</sup> E                |         |                 | S 65 <sup>th</sup> W |       |         | 5.00            | S 70 <sup>th</sup> E |       |         | 21.00           |     |
| S 79 <sup>th</sup> E                |         |                 | S 47 <sup>th</sup> W |       |         | 1.00            | S 81 <sup>th</sup> E |       |         | 19.25           |     |
| S 85 <sup>th</sup> E                |         |                 | S 47 <sup>th</sup> E |       |         | 6.00            | S 15 <sup>th</sup> W |       |         | 4.00            |     |
| S 6 <sup>th</sup> E                 |         |                 | S 15 <sup>th</sup> W |       |         | 4.00            |                      |       |         |                 |     |

Total number of Acres 21,917.04

| Surveys designated | By whom surveyed     | Date of Contract. | Amount of Surveys |      | When surveyed                                |
|--------------------|----------------------|-------------------|-------------------|------|--|
|                    |                      |                   | M.                | Lks. |  |
| Township lines E.  | William Brewt        | May 21 1856       |                   |      | 1856   |
| N. S. & W.         | C. R. & C. E. Stuntz | March 12 1867     |                   |      | 1867   |
| Retraced S. & E.   | Kindred & Caldwell   | Janva. 1 1881     | 12.00             | 00   | 1881   |
| Subdivisions       | same                 | same              | 59.16             | 99   | Commenced Jan. 17 1881<br>Completed Feb. 5 " |
| Meanders           |                      |                   | 28.52             | 50   |  |
| Total              |                      |                   | 100.19            | 49   |  |

The above Map of Township No 54 N. of Range No 16 W. of the 4<sup>th</sup> Principal Meridian Minnesota is strictly conformable to the field notes of the survey thereof on file in this Office which have been examined & approved.

Surveyor General's Office,  
St. Paul, March 10<sup>th</sup> 1881

*J. H. Stewart*  
Surr. Genl.