

Township No 53 N Range No 16 W 4th Mer. Minnesota.

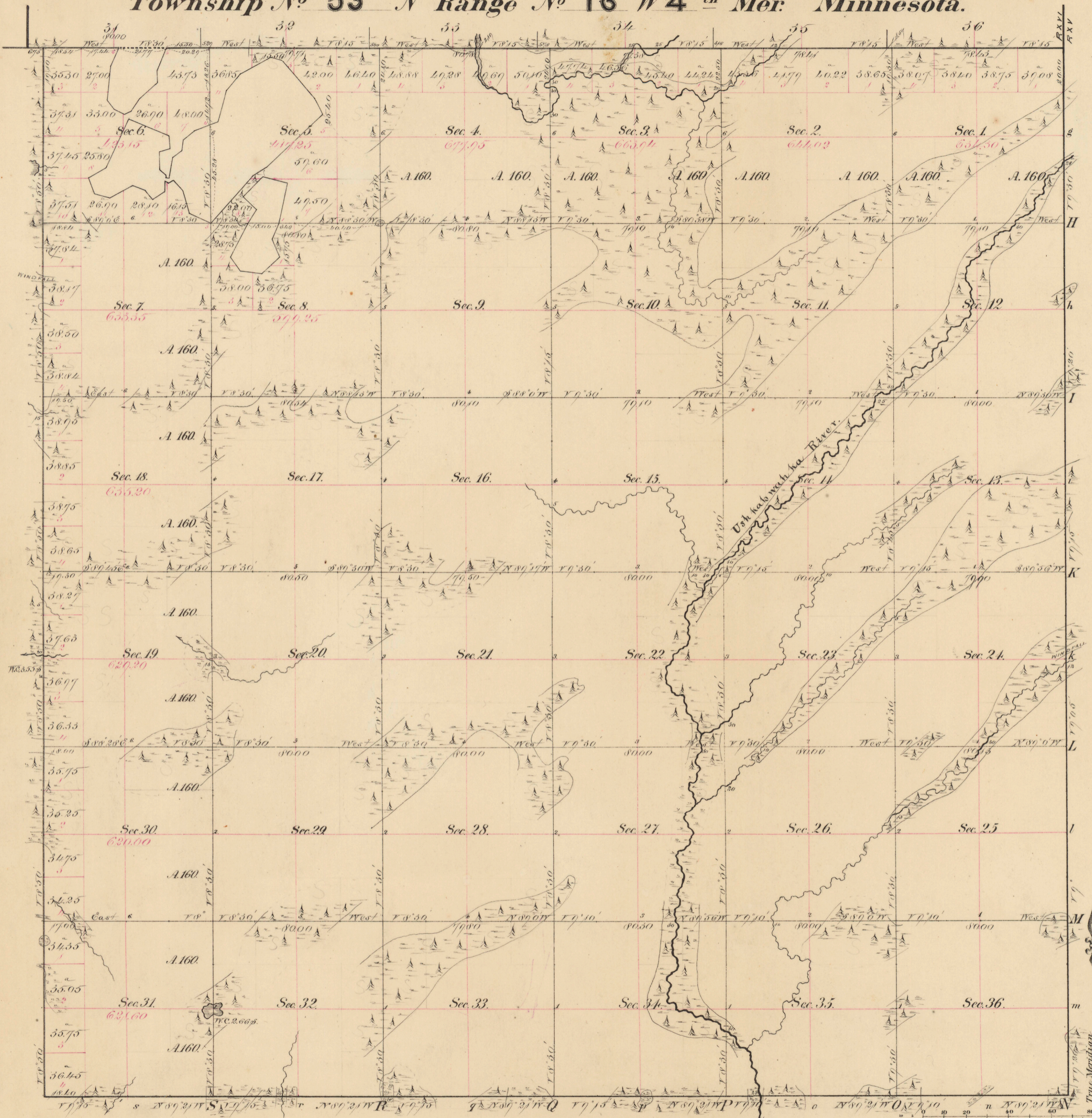

| Meanders of | | | | | | | | |
|-------------|---------|-----------------|-----------------|-------|---------|-----------------|-----------------|-------|
| Posts | Courses | Ch ^s | Lk ^s | Posts | Courses | Ch ^s | Lk ^s | Posts |
| | | | | | | | | |
| | | | | | | | | |
| | | | | | | | | |
| | | | | | | | | |
| | | | | | | | | |
| | | | | | | | | |
| | | | | | | | | |
| | | | | | | | | |
| | | | | | | | | |
| | | | | | | | | |
| | | | | | | | | |
| | | | | | | | | |
| | | | | | | | | |
| | | | | | | | | |
| | | | | | | | | |
| | | | | | | | | |
| | | | | | | | | |
| | | | | | | | | |
| | | | | | | | | |
| | | | | | | | | |
| | | | | | | | | |
| | | | | | | | | |
| | | | | | | | | |
| | | | | | | | | |

Meanders 6 Miles 68 Chains 30 Links

Total number of Acres. 22,359.21

| Surveys Designated | By Whom Surveyed | Date of Contract | Amount of Surveys M Ch ^s Lk ^s | When Surveyed |
|---------------------|------------------|------------------------------|--|--|
| Township lines East | Wm Burt | May 21 st 1856 | | 1856 |
| North | Geo. R. Stuntz | March 12 th 1867 | | 1867 |
| West & South | Jerrett & Howe | August 11 th 1870 | | 1870 |
| Subdivisions | Stuntz & Howe | August 5 th 1870 | 66 - 28 - 39 | Commenced Dec 20 th 1870 Completed Dec 20 th 1870 |

The above Map of Township No 53 N of Range No 16 W of the 4th Principal Meridian Minnesota is strictly conformable to the field notes of the survey thereof on file in this Office which have been examined and approved.

Surveyor General's Office. *C. J. Brown*
St Paul April 27th 1871

Sur. Gen.